



# SCHEDULE 2024

## Global Lifelong Learning Week



University College Cork, Cork, Ireland



27th–31st May



ASEM  
Lifelong Learning  
THE YEAR 2020-2025

**ASEM LLL Hub  
Conference**  
27th–30th May  
**#ASEMLLLHub**



**54th eucen Conference**  
29th–31st May  
**#WeAreEucen**

**#GLLLW2024**



ASEM Lifelong Learning  
IRELAND 2020-2025



**UCC**

Coláiste na hOllscoile Corcaigh, Éire  
University College Cork, Ireland

**ACE**  
ADULT CONTINUING EDUCATION AT UCC



[www.asemlllhub.org](http://www.asemlllhub.org)

## Contents

3 About Global Lifelong Learning Week

ASEM LLL Hub Conference

4 Prayer Room Information

4 Monday Schedule

5 Tuesday Schedule

6 Wednesday Schedule

7 Thursday Schedule (South Asia Stakeholders Workshop)



54th eucen Conference

8 Wednesday Schedule

8 Thursday Schedule

9 Friday Schedule



10 Panel Sessions

11 Creating Synergies Flash Session

13 Keynote Speakers

18 eucen Parallel Sessions

18 Parallel Session One (Thurs 30th at 10am)

19 Parallel Session Two (Thurs 30th at 12pm)

20 Parallel Session Three (Fri 31st at 9.15am)

21 Poster Sessions

21 eucen Poster Session

22 Social Experiences

24 Abbreviations

25 Maps & Locations

## About Global Lifelong Learning Week

The 2024 Global Lifelong Learning Week is scheduled to take place from the 27th to the 31st of May 2024 at University College Cork, Ireland.

This week-long global event will host the ASEM LLL Hub Conference on Monday 27th to Thursday 30th, and the 54th annual eucen (European University Continuing Education Network) Conference from Wednesday 29th to Friday 31st.

This week will be an exciting opportunity for researchers, policymakers, educators and stakeholders from five continents to gather, network, share insights and discuss opportunities for collaboration.

### About ASEM LLL Hub

The ASEM LLL Hub offers Europe and Asia an unparalleled mechanism for engaging in high-level, policy-oriented research on common futures. It provides opportunity for Europe and Asia to work together to innovate, to achieve excellence in comparative lifelong learning and to contribute to evidence-based educational reform.



### About eucen

eucen is the largest multidisciplinary European association of university lifelong learning (ULLL) and university continuing education, with over 32 years of experience and wide expertise in the field. eucen's main aims are to contribute to the development and improvement of ULLL in universities and to promote and advance ULLL at the European policy level.





ASEM  
Lifelong Learning  
2020-2025

# ASEM LLL Hub Conference

## 27th–30th May



### Prayer Room

Mon 27th - Wed 29th

Room WW7 is the allocated prayer room. It will be available for use from 9am to 6pm Monday 27th – Wednesday 29th May 2024 inclusive.

WW7,  
Main Quad

### Monday

May 27th

08.30–09.00 Registration with tea/coffee Aula Maxima

09.00–10.00 **Official Opening of Global Lifelong Learning Week** Aula Maxima  
**Prof. John O’Halloran**  
 President, University College Cork  
**Ms Vera Lucke**  
 Deputy Head, ASEM Education Secretariat  
**Dr Séamus Ó Tuama**  
 Chair ASEM LLL Hub/ACE at UCC

10.00–11.15 **Keynote Address: “Adult Education: The Singapore Approach”** Aula Maxima  
**Mr Yeo Li Pheow**  
 Executive Director at Institute for Adult Learning (IAL) Singapore  
 Followed by a discussion panel on expanding the lifelong learning agenda including skills and TVET with:  
**Mr Pedro Moreno Da Fonseca**  
 Technical Specialist, ILO  
**Ms Chiara Riondino**  
 Head of Vocational Education and Training at European Commission

11.15–12.15 **Networking & Coffee** Dr Dora Allman Room,  
The Hub  
 ASEM in Practice Poster Session  
 Cork Prison Micro-credentials Exhibition

12.15–13.30 **Panel One:** Aula Maxima  
**Key Policy Imperatives for International Lifelong Learning**  
**Moderator: Mr Reinhard Nöbauer**  
 Senior Expert, Austrian Federal Ministry for Education, Science & Research  
**Amb. Toru Morikawa**  
 Executive Director, ASEF  
**Dr Roger Yap Chao Jr**  
 Head of Education, Youth and Sports, ASEAN Secretariat  
**Dr Ethel Agnes Valenzuela**  
 Commissioner/Vice Minister for Higher Education, Philippines  
**Mr Denis Leamy**  
 Chief Executive Cork ETB, Chair of OECD LEED Directing Committee  
**Respondent: Prof. Mike Osborne**  
 ASEM LLL Hub, University of Glasgow

13:30–14:45 **Lunch** Aula Maxima





ASEM  
Lifelong Learning

# ASEM LLL Hub Conference

## 27th - 30th May



**14:45–15:45**    **Panel Two:** **Agile, Responsive & Resilient: Lessons from Asia**    **Aula Maxima**

**Moderator: Dr Shalini Singh**

Director of Center for Lifelong Learning, University of Science & Technology  
Meghalaya, ASEM LLL Hub South Asia Coordinator

**Dr Ai Songheang**

Director, SEAMEO TED

**Dr Sheikh Lukman S A Hamid**

Director of LifeLong Learning Centre, Brunei Darussalam

**Asst. Prof. Dr Romyen Kosaikanont**

Centre Director, SEAMEO RIHED

**Respondent: Dr Suwithida Charungkattikul**

Director, General Education Center, Chulalongkorn University, ASEM LLL Hub  
Southeast Asia Coordinator

**15:45–16:30**    **Stop Procrastinating: Five Easy Steps to Start Writing a JCHE Article (For Those Who Have Been Thinking About It Too Long)**    **Aula Maxima**

**Mr Walter Pearson**

Editor, Journal of Continuing Higher Education

**16:30–17:30**    **Creating Synergies Flash Session**    **Aula Maxima**  
**AI, Sustainability, Access to Education for Girls and Women**

**18.00–19.30**    **Drinks Reception**    **Common Room, Main Quad**

### Tuesday

May 28th

**09.00–09.45**    **Keynote Address: A European Outlook on Lifelong Learning – with a Pedagogical Stance**    **Aula Maxima**

**Dr Marit Honerød Hoveid**

Secretary General, EERA

**9.45–11.00**    **Panel Three:** **Inter-regional Perspectives on University Lifelong Learning**    **Aula Maxima**

**Moderator: Ms Réka Tózsá**

Director of Education, ASEF

**Mr Uwe Gartenschläger**

Director, DVV International, President, EAEA

**Dr Fergal Finnegan**

Maynooth University, Ireland, Vice Chair, ESREA

**Dr Christy Rhodes**

President, COLLO

**Respondent: Prof. Karen Evans**

Emeritus Professor, Institute of Education, UCL

**11.00–11.30**    **Networking & Coffee**    **Aula Maxima**





ASEM  
Lifelong Learning

# ASEM LLL Hub Conference

## 27th - 30th May



11.30–12.45	<b>Panel Four: Making Lifelong Learning Real</b> <b>Moderator: Prof. Yukiko Sawano</b> University of Sacred Heart, ASEM LLL Hub <b>Mr Jorge Blando Martínez</b> President, RECLA <b>Mr Pascal Paschoud</b> President, EUCEN <b>Prof. Vinay Pathak</b> President, Association of Indian Universities, Vice Chancellor, CSJMU, India	Aula Maxima
12:45–14.00	<b>Lunch</b>	Aula Maxima
14:00–15:30	<b>Research Network Seminars</b> RN 1..... North Wing Council Room, Main Quad RN2..... Aula Maxima	
15.30–16.00	<b>Networking &amp; Coffee</b>	Aula Maxima
16:00–17:30	<b>Research Network Seminars (2)</b> RN 3..... Aula Maxima (Hybrid Session) RN 5..... North Wing Council Room, Main Quad	
17.30–18.30	<b>Walking Tour of Cork</b>	Departing from Main Gates UCC
18:30–20:30	<b>Social Activity</b> Dinner and Traditional Irish Music	 Marina Market

### Wednesday

May 29th

09.00–11.00	<b>International Advisory Council Meeting (ASEM Members)</b>	Dora Allman
11.00–11.30	<b>Networking &amp; Coffee</b>	Dora Allman
11.30–13.30	<b>Visit to Cork Learning City Projects</b>	Off campus

eucen Conference to commence. Please note if you are attending both eucen and ASEM LLL Hub Conferences, you must re-register for the eucen conference at this time. Go to page 8.

16.30–18.00	<b>Irish Food Lecture</b>	WGB G01
16.30–18.00	<b>UCC Campus Tour</b>	Visitors Centre, North wing, Main Quad
16.30–18.00	<b>Research Network Seminars (3)</b> RN 4..... TBC RN 7..... WGB G13	
19.00	<b>Global Networking Dinner - Izz Cafe</b> (Invite Only)	 Izz Cafe





ASEM  
Lifelong Learning

# ASEM LLL Hub Conference 27th - 30th May



## Thursday

May 30th

11.00–13.30	South Asia Stakeholders Workshop (ASEM LLL Hub) Session 1	1.06 WGB
13.30–14.30	Networking & Coffee	TBC
14.30–18.00	South Asia Stakeholders Workshop (ASEM LLL Hub) Session 2	1.06 WGB
16.00–16.30	Networking & Coffee	TBC
16.30–18.00	South Asia Stakeholders Workshop (ASEM LLL Hub) Session 3	1.06 WGB

While participating in the workshops and seminars in The Hub in UCC, consider popping by Roots Coffee Shop, located on the ground floor, behind the Aine Hyland Room. Set up by Cope Foundation (a local charity) the cafe provides work experience and employment opportunities for young people with intellectual disabilities. The café train adults in barista skills, customer service, communication, and cash handling.

Sustainability is an important part of Roots UCC. There are no disposable takeaway cups and any food that is not sold on the day is donated to staff and students in UCC.

The cafe opens Monday-Friday from 10am - 3pm.





# 54th eucen Conference

## 29th - 31st May



### Wednesday

May 29th

#### eucen Pre-conference

09.00–11.30	<b>eucen Steering Committee Meeting</b> (CLOSED)	Aine Hyland Room, The Hub
11.30–13.00	<b>eucen National LLL Networks Meeting</b> (CLOSED)	Aine Hyland Room, The Hub

#### eucen Conference

13.30–14.30	<b>eucen Registration with Tea/Coffee Welcome</b>	Atrium WGB
14.30–15.00	<b>eucen Conference Welcome</b> <b>Prof. Paul McSweeney</b> VP for Learning & Teaching, UCC <b>Ms Lyndsey El Amoud</b> Deputy Director, ACE at UCC, eucen Steering Committee	WGB G05
15.00–16.00	<b>Keynote Address</b> <b>Prof. Steven Frye</b> President AAACE, Director, Professor School of Interdisciplinary Studies Tennessee Technological University	WGB G05
16.00–16.30	<b>Networking &amp; Coffee</b>	Atrium WGB
16.30–18.00	<b>Irish Food Lecture</b>	WGB G01
16.30–18.00	<b>UCC Campus Tour</b>	Visitors Centre, North Wing, Main Quad
16.30–18.00	<b>HELLIN Meeting</b> (Closed Session)	WGB 2.26
18.00–19.00	<b>eucen Drinks Reception</b> (eucen members only)	Atrium WGB

### Thursday

May 30th

9.15–10.00	<b>Keynote Address: To Learn Is To Live, Education Was My Rebirth</b> <b>Ms Deborah Oniah</b> Lawyer and UCC Sanctuary Scholar	WGB G05
10.00–11.30	<b>Parallel Session 1</b>	WGB G02, G08, G14, G15, G18





# 54th eucen Conference

## 29th - 31st May



11.30–12.00	Networking & Coffee	Atrium, WGB
12.00–13.30	Parallel Session 2	WGB G02, G08, G14, G15
13.30–14.45	Lunch	Atrium, WGB
14.45–15.45	<b>Keynote Address: Learning from Life - Exclusion and Discrimination in the Education System</b> <b>Ms Anne Burke</b> Southern Traveller Health Network <b>Chair: Olive Byrne</b> Head of Access, UCC	WGB G05
15.45–17.45	eucen General Assembly (Delegates only)	WGB, G05
17.30–18.30	Walking Tour of Cork	Departing from Main Gates UCC
18.30–20.30	<b>Social Activity</b> Dinner and Traditional Irish Music	 Marina Market

### Friday May 31st

9.15–10.45	Parallel Session 3	WGB G02, G08, G14, G15, G18
10.45–11.30	<b>Networking &amp; Coffee</b> Learning Neighbourhood Exhibition & eucen Poster Session	Atrium, WGB
10.45–11.30	Meet the EJULL Editorial Board	Room TBC
11.30–12.30	<b>eucen Panel Discussion:</b> <b>Working in Partnership: Bringing the University to the Community</b> <b>Moderator: Dr Leslie Cordie</b> Associate Professor, Adult Education Program, Auburn University <b>Ms Brikena Xhomaqi</b> Director, Lifelong Learning Platform, Co-Chair EESC Civil Liaison Group <b>Mr Donald Tracy</b> Director, Continuing Education Division, Austin Community College, Texas <b>Ms Melanie Redman</b> Co-Founder and President & CEO at A Way Home, Ashoka Fellow <b>Dr Séamus Ó Tuama</b> Chair ASEM LLL Hub, ACE at UCC <b>Dr Robert J Hansen</b> CEO at UPCEA	WGB G05
12.30–12.50	Closing & Upcoming eucen Events	WGB G05
13.45–17.45	<b>Social Activity Including Lunch</b> Jameson Distillery (or) Blarney Castle & Gardens	 Departing from UCC



## Panel Sessions

There are a number of panels and sessions taking place across the two Conferences during Global Lifelong Learning Week. Please find more information on the sessions and speakers here:

### Panel One

Key Policy Imperatives for International Lifelong Learning

10.00am  
Mon 27th



**Mr Reinhard Nöbauer**  
Senior Expert, Austrian Federal  
Ministry for Education, Science &  
Research

Moderator



**Amb. Toru Morikawa**  
Executive Director, ASEF



**Dr Roger Yap Chao Jr**  
Head of Education, Youth and  
Sports, ASEAN Secretariat



**Dr Ethel Agnes Valenzeula**  
Commissioner/Vice Minister for  
Higher Education, Philippines



**Mr Denis Leamy**  
Chief Executive, Cork ETB, Chair,  
OECD LEED Directing Committee



**Prof. Mike Osborne**  
ASEM LLL Hub, University of Glasgow

Respondent



### Panel Two

Agile, Responsive & Resilient: Lessons from Asia

14.15pm  
Mon 27th



**Dr Shalini Singh**  
Director, Center for Lifelong Learning,  
University of Science & Technology  
Meghalaya, ASEM LLL Hub South Asia  
Coordinator

Moderator



**Dr Ai Songheang**  
Director, SEAMEO TED



**Dr Sheikh Lukman S A Hamid**  
Director, LifeLong Learning Centre,  
Brunei, Darussalam



**Asst. Prof. Dr Romyen Kosaikanont**  
Centre Director, SEAMEO RIHED



**Dr Suwithida Charungkattikul**  
Director, General Education Center,  
Chulalongkorn University, ASEM LLL  
Hub Southeast Asia Coordinator

Respondent



## Creating Synergies

AI, Sustainability & Climate, Access to Education for Girls and Women

 16.30pm  
 Mon 27th

Each Flash Session is to offer a very short presentation (10-15 minutes maximum) with a very short Q&A. It is aimed at prompting thinking on how each of the networks, and ASEM LLL Hub as a whole, can begin to think about how to engage with these cross-cutting issues.



### AI

Lead: Dr Long Pham  
 Respondent: Dr Zan Chen



### Sustainability & Climate

Lead: Dr Shalini Singh  
 Respondent: Ms Mo Winnie Wang





### Education and Learning for Girls and Women

Lead: Dr. Zenaida Q. Reyes  
 Respondent: Dr Usha Titus

## Panel Three

Inter-regional Perspectives on University Lifelong Learning

 9.45am  
 Tues 28th



**Ms Réka Tózsza**  
 Director of Education, ASEF

Moderator 



**Mr Uwe Gartenschläger**  
 Director, DVV International,  
 President, EAEA



**Dr Fergal Finnegan**  
 Maynooth University, Ireland, Vice  
 Chair, ESREA



**Dr Christy Rhodes**  
 President, COLLO



**Prof. Karen Evans**  
 Emeritus Professor, Institute of  
 Education, UCL

Respondent 

### Panel Four

Making Lifelong Learning Real



11.30am

Tues 28th



**Prof. Yukiko Sawano**  
University of the Sacred Heart/ASEM LLL Hub

Moderator



**Prof. Vinay Pathak**  
President, Association of Indian Universities, Vice Chancellor, CSJMU, India



**Mr Jorge Blando Martinez**  
President, RECLA



**Mr Pascal Paschoud**  
President, EUCEN, Executive Director @ Formation Continue UNIL-EPFL



### eucen Panel Discussion

Working in Partnership: Bringing the University to the Community



11.30am

Fri 31st



**Dr Leslie Cordie**  
Adult Education Program, Auburn University

Moderator



**Ms Melanie Redman**  
Co-Founder and President & CEO at A Way Home, Ashoka Fellow



**Ms Brikena Xhomaqi**  
Director, Lifelong Learning Platform, Co-Chair EESC Civil Liaison Group



**Dr Séamus Ó Tuama**  
Chair ASEM LLL Hub, ACE at UCC



**Mr Donald Tracy**  
Director, Corporate & Community Education, Continuing Education Division, Austin Community College, Texas



**Dr Robert J Hansen**  
CEO at UPCEA



## Keynote



### Yeo Li Pheow

---

Executive Director at Institute for Adult Learning Singapore

### Shaping Policy for Skills

Assoc Prof Yeo Li Pheow helms the Institute for Adult Learning as its Executive Director since March 2023. Prior to that, Assoc Prof Yeo's illustrious career with the Polytechnics in Singapore dated back to 1990 and he was the Principal & Chief Executive Officer of Republic Polytechnic for close to 15 years before joining IAL.

Assoc Prof Yeo graduated with a Bachelor Degree in Economics (Accountancy major) from Macquarie University, Australia in 1983 through the Australian Assistance Development Bureau Scheme. In 1993, he completed his Master Degree in Business Administration at the Institut Supérieur de Gestion (ISG), France, through a scholarship jointly awarded by ISG through the Ministry of Foreign Affairs, Singapore and Temasek Polytechnic. In 2013, Assoc Prof Yeo completed the Advanced Management Programme at Harvard Business School.

Assoc Prof Yeo is a Fellow of the Australian Society of CPAs, an Associate of The Institute of Chartered Secretaries and Administrators (UK) and an Associate of the Staff Education Development Association (UK). He is also a professional member of the Singapore Human Resources Institute. He was conferred the award of Honorary Doctor [Dr. (h.c.)] of the James Cook University in 2018 in recognition of his exceptional services that have significantly contributed towards the advancement of the James Cook University.

Monday 27th | 10am



## Keynote



### Dr Marit Honerød Hoveid

President-elect EERA

### A European outlook on lifelong learning – with a pedagogical stance

Prof Marit Honerød Hoveid was elected as incoming EERA President from September 2023 for a period of four years. Prof Honerød Hoveid is Professor of Pedagogy, PhD, at Norwegian University of Science and Technology, Department of Education and Lifelong Learning and has held numerous academic roles in Norwegian education in the course of a long and varied career. She has been deeply involved in the work of EERA for a number of decades and has acted as:

- Link-Convenor Network 10, Teacher Education Research (2004-2008)
- Network's Representative on Council, European Educational Research Association (2008-2011)
- Secretary General (2011-2016)

Tuesday 28th | 9am



## Keynote



### Dr. Steven Frye

President of AAACE and Director of the School of Interdisciplinary Studies at Tennessee Technological University

Dr. Steven Frye is a Professor/Director of the School of Interdisciplinary Studies at Tennessee Technological University in Cookeville, Tennessee. He holds a Ph.D. in Education, with a specialization in Adult Education, from the University of Tennessee. He teaches courses in Adult Learning, Critical Thinking and Problem Solving, Religious Studies, and Freshman Experience. His research interests include adult learning and conceptual change, student engagement, adult students in higher education, and adult religious education. Dr. Frye currently serves as president of the American Association for Adult and Continuing Education (AAACE) and is Immediate Past Chair of the Association for Continuing Higher Education, South Region (ACHE-S).

Wednesday 29th | 3pm



european university  
continuing education network



## Keynote



### Deborah Oniah

Lawyer & Sanctuary Scholar

**“To Learn is to Live, education was my rebirth”**

Deborah Odeworitse Oniah, is a Lawyer, writer and a mother of four. She is currently doing her Masters in Child Right and Family Law in UCC.

She is a University College Cork Sanctuary Scholar with a Postgraduate Diploma in Trauma Studies. Deborah is an important voice for the migrant community in Ireland, Deborah is trained in and facilitates intercultural dialogue, she also facilitates the Culturally Relevant Parenting Programme training across direct provision centres in Cork.

She is one of the founding members of the CMC Women Coffee Morning group that has been running for 6 years in Nano Nagle Place where she now volunteers. She is a member of Sanctuary Runners and Saoirse Ethnic Hands On Deck, a registered social enterprise project run by migrant women living in Direct Provision Centres in Cork. She has just completed Global Youth Work and Development at University of Maynooth, Kildare. Deborah advocates for adult learning and women’s health. She is a member of Board Aontas.

Thursday 30th | 9.15am





## Keynote



### Anne Burke

Southern Traveller Health Network

### Beyond the University Learning from Life - Exclusion and Discrimination in the Education System

Anne Burke works with the Southern Traveller Health Network. Anne was also co-ordinator and lecturer on a pioneering initiative which saw 21 Traveller women graduate from UCC following the completion of a Level 6 Leadership in the Community course with ACE at UCC. The course was co-created by the Southern Traveller Health Network (STHN), Adult Continuing Education (ACE), supported by Access UCC, and funded by the SOAR Project. Anne works tirelessly to advocate for the travelling community, to increase participation in education initiatives and achieve equality of education for Travellers.

Note: The Irish government recognises the Traveller community as a distinct ethnic group in Ireland

Thursday 30th | 2.45pm



## Parallel Session One



10am  
Thurs 30th

### Microcredentials: Perspectives from Across Europe

 WGB G08

Chair: Mags Arnold, UCC Microcreds Project Lead



Monica Bravo Granström, University of Education Weingarten & Alexandra Jürgens, University Aalen  
**Empowering Lifelong Learning: The German Approach to Structuring and Recognising University Continuing Education**



Jana Arbeiter, University of Ljubljana, Tamara Boh, Andrej Kos & Ksenija Vidmar Horvat  
**Microcredentials at University of Ljubljana, Slovenia: Challenges and Opportunities**



Brian Shee, University of Limerick, Geraldine Carroll & Dr. Sarah Brady  
**Micro-credentials: Developing Inclusive and Accessible Education Opportunities**



Robert Piazza, University of Catania, Marta Ghisi, Salvatore Patera & Fausta Scardigno  
**Microcredentials: Fostering Lifelong Learning and Adapting Universities to the New Reality - A Strategic Vision from RUIAP**



Ülle Kesli, University of Tartu & Tiia Ristolainen  
**From Zero to One Hundred with Three Years: University of Tartu Experience in Introducing Micro-credentials**

### Perspectives on ULLL: Challenges & Solutions

 WGB G02

Chair: Prof. Paul McSweeney, VP Office of Learning and Teaching, UCC



Alison McDonald, Oxford University Department for Continuing Education & Matthew Weait  
**Steering the Tanker: Realising Strategic Ambition in Lifelong Learning at the University of Oxford**



Aurelia Braguta, Academy of Economic Studies of Moldova  
**The Role of Universities in Developing Lifelong Learning (LLL) in the Republic of Moldova**



Dr Tony Murphy, South East Technological University  
**Location, Location, Location: Finding a Home for Lifelong Learning in the New University**



Nora Trench Bowles, Irish Universities Association  
**Adapting the Irish Higher Education System to Support the Role of the University in Lifelong Learning**



Lyndsey El Amoud, University College Cork  
**Challenges & Solutions for Implementing Lifelong Learning in Higher Education in Ireland**

### PartnerUp Erasmus+ Project Workshop: Partnership for a better implementation of upskilling pathways

 WGB G14

Chair:



Carme Royo, eucen & Elisabetta Virginelli  
**Partnership for a Better Implementation of Upskilling Pathways**

### European University Alliances (EUAs) Outreach Workshop: Enhancing Opportunities for Lifelong Learning (LLL) in European University Alliances

 WGB G18

Chair:



Dr. Beate Hörr, Johannes Gutenberg University Mainz, Päivi Kananen, University of Jyväskylä, Finland; FORTHEM & Silvia Gallagher University of Dublin, Ireland; Charm-EU  
**European University Alliances (EUAs) Outreach Workshop: Enhancing Opportunities for Lifelong Learning (LLL) in European University Alliances**

**Putting the Flexibility in ULL**  
Chair:

 **WGB G15**

-  Benedicte Seynhaeve, KU Leuven & Jorie Soltic  
**Strategic Stacking: The Integrated Modular Approach to Industry-Driven Lifelong Learning**
-  Vladana Vidric, University of Natural Resources and Life Sciences Vienna, Christina Paulus, Martin Mayr & Andreas Mandler  
**Re/Upskilling the Agricultural Labour Force: Micro-credentials as Innovative LLL Strategy**
-  Ahidoba de Franchi Mandscheff, University of Geneva – Centre for Continuing and Distance Education  
**Let's Not Just Support Student Learning, Let's Support Adult Learning Too!**
-  Rosette S'Jegers, Free University Brussels/ Vrije Universiteit Brussel, Lieve Van den Brande, Free University of Brussels & Jo Angouri, University of Warwick  
**Flexible Mechanisms for Lifelong Learning in Higher Education: The Fleclab Case**

**Parallel Session Two**

 **12pm**  
 **Thurs 30th**



**Making inclusion a reality in ULLL**  
Chair:

 **WGB G08**

-  Goof Claessen, Radboud University, S. Grotenhuis, University Utrecht, S. Nuijten, University Amsterdam & K. Vernailen, Wageningen University  
**Case Study Learning Community UCE in the Netherlands**
-  Christy Rhodes, Coalition of Lifelong Learning Organizations/ East Carolina University  
**A Study of Immigrant Integration in a New Gateway State**
-  Ben Grant, University of Oxford  
**Designing Educational Workshops for Refugees and Asylum Seekers**
-  Laura Widger, South East Technological University, Professor Meg Benke & Dr Sergio Botelho Junior  
**Enhancing Access to Higher Education by Integrating Greater Equality, Diversity and Inclusion in the Recognition of Prior Learning**
-  Elisabetta Verginelli & Aisha Krueger, eucen  
**INCLUDE ME+ Making Digital Media a Vehicle for Inclusion**

**Enhancing ULLL: Tools & Strategies**  
Chair:

 **WGB G02**

-  Deirdre Goggin, Professor Irene Sheridan, Professor Margaret Linehan, Munster Technological University  
**Systemic Challenges to the Implementation of RPL Within Higher Education in Ireland**
-  Dr. Stefanie Kröner, Miriam Chebbah, Dr. Aletta Hinsken, evalag (Evaluationsagentur Baden-Württemberg)  
**Challenges and Possible Solutions Within the Quality Development and Professionalisation of CPD in Baden-Württemberg**
-  Minna Kallinen-Kuisma, Antti Laitinen, Jukka Lerkkanen, University of Jyväskylä  
**Value-Based ULLL Strategy as a Tool for the New Reality**
-  Benoit Berthou, University Sorbonne Paris North/French University LifeLong Learning Education Network  
**French Universities' Quality Approach: A Positive Change for LLL Development**
-  Balázs Németh, Aisha Krueger, University of Pécs and MELLearn-Hungarian Universities LLL Network  
**Enabling a Culture of LLL in Universities Through National Networking – Choices and Limitations for Quality Higher Education**

**Bringing the University to the Learner: Fairground, Learning Centres and Learning Neighbourhoods**  
Workshop

 **WGB G15**

-  Dr Séamus Ó Tuama, University College Cork, Michael Tobin, Eric Agbessi & Denis Barrett  
**Bringing the University to the Learner: Fairground, Learning Centres and Learning Neighbourhoods**

## A Maturity Model for European Micro-credentials Workshop

 WGB G14

 Paul den Hertog, SURF, Neill Wylie, Kerstin Schoerg & Godelieve van den Brande  
**A Maturity Model for European Micro-credentials**

## Parallel Session Three

 9.15am  
 Fri 31st

## A focus on online learning in ULLL (roundtable/workshop)

 WGB G08

Chair:

 Tracey-Lee Davis, Delft University of Technology  
**Redefine Design and Delivery for Lifelong Learners**

 Lisa Breitschwerdt, Christina Hümmer, Regina Egetenmeyer, Julius-Maximilians-Universität Würzburg  
**Design Requirements of Synchronous Hybrid Settings in University Teaching. A Learners Perspective on Participant-Sensitive Formats**

 Roxana Toma, Ali Ait Si Mhamed, SUNY Empire State University  
**Empowering Non-Traditional Learners in Online Education: An Analysis of the Enablers and/or Barriers to Learning Embedded in Course Design and Pedagogy**

 Tricia Berry, Purdue University Global  
**Incorporating Experiential Learning Into Online Programs**

## Partnerships in Practice in ULLL

 WGB G18

Chair: Deirdre , Access Officer, UCC

 Maria Lotty, University College Cork  
**A University – Child Welfare Agency Collaboration supporting graduate level professional continuing education: The TARA Project**

 Camilla Fitzsimons, Maynooth University  
**Reframing Feminism – The Role of Community Education**

 Helen Murphy, South East Technological University  
**SETU & An Cosán: Using the Power of Community Education To Create Transformative Higher Education Pathways for Social Inclusion and Sustainable Development**

 Muru Linjala, Maija Riitaoja, Open University of the University of Jyväskylä  
**Open University of the University of Jyväskylä Building Regional Partnerships To Enhance the ULLL Guidance Services in Central Finland**

## Creating Sustainable Partnerships for Successful ULLL Programmes (Workshop)

 WGB G15

Chair:

 Wim de Boer, Marije Hahnen-Florijn, Astrid van Os, University of Twente  
**Lessons Learned and Yet To Be Learned in Creating Sustainable Partnerships for Successful ULLL Programs**

## eucen Steering Committee Workshop

 WGB G02

Chair:

 eucen Steering Committee Group: Matthew Weait, Pascal Paschoud and Lyndsey El Amoud  
**eucen ULLL Leadership Network**

## Supporting the Learning Experience: Tools & Approaches for ULLL

Chair: Steve O'Brien

 WGB G14

-  Dr Annemieke Maas, University Medical Center Utrecht, Dr Stefan van Geelen, The New Utrecht School and UMC Utrecht and Prof. Dr Annet van Royen-Kerkhof, UMCU and UMC Utrecht  
**Training Situational Awareness Through the Arts: A Lifelong Learning Perspective**
-  Hanne Ten Berge, Wieger Bakker, Ineke Lam & Frans Prins, Utrecht University  
**What Do They Wish For? Needs of Professionals in University Continuing Education**
-  Caitriona Warren & Dr Eleanor Neff, South East Technological University  
**Empowering Lifelong Learners Through Autonomy**
-  Sanne Elling, Ineke Lam & Hanne ten Berge Utrecht University  
**Opportunities and Challenges in Assessment of Continuing Education**
-  Finola McCarthy, University College Cork and Leslie Cordie  
**Concept-Mapping the Curriculum Design Processes of Adult Educators in Higher Education: Lessons From Practice at ACE in UCC**

## Poster Session

 10.45am  
 Fri 31st

-  Dr. Tamer Atabarut & Elif Yıldız, Bogazici University Lifelong Learning Center  
**Linking Citizenship and Employability: LICEAL Project**
-  Valerie Brett & Lucy Hearne, South East Technological University  
**Can Athena SWAN work for FET?**
-  Diana Treviño-Eberhard, eucen  
**Democrat Project - Strengthening Liberal Democracy through Lifelong Learning**
-  Aisha Krüger & Carme Roya, eucen  
**The SIM Project: Bringing Together Education, Corporate Social Responsibility and Business to Create the Social Impact Manager**
-  Viire Sepp, University of Tartu  
**Third Age University – the Opportunity To Be Socially Active and Keep Up With the Rapidly Changing World**
-  Sandrine Bonnet & Pascal Millo, University of Lille  
**French National strategy "ASDES" and the development of Continuing Education at the University of Lille through EXIST (Executive Programme in Innovation and Social Transitions)**

## Experiences

Please note places on these experiences are limited and should be pre-booked when registering for the conferences.



### Cork Walking Tour

Enjoy a fascinating tour through Cork's ancient past. Enjoy tales of days gone by, witness the remnants of our medieval city and embrace Cork's local heritage with tour guide and design art historian Tom Spalding. The walking tour will depart from UCC at 5.30pm and conclude at Marina Market at 6.30pm.

**Tues 28th & Thurs 29th | 17.30–18.30**

Departing from UCC Main Gates



### UCC Campus Tour

Join a guided tour and become immersed in the rich history of University College Cork. UCC's campus is full of many interesting buildings and features.

The tour visits the Main Quadrangle, the Ogham Stones Corridor in the Main Quadrangle, Presidents Garden, Honan Chapel, George Boole Statue, Crawford Observatory and the University Mace at Visitor Services.

**Wed 29th | 16.30–18.00**

Departing from the Main Quad Visitor Centre



### Marina Market

The Marina Market is Cork's largest indoor and outdoor market and food hall near Cork's Greenway. Formerly a warehouse, it was converted and then opened to the public in 2020, hosting over 30 food and drink vendors serving street food inspired by various global cuisines.

Attendees will enjoy a casual dining experience followed by a live performance of traditional Irish music and dance by popular group Uilleann Ceoil. Attendees will be invited to participate in our traditional Irish dances including The Siege of Ennis, Shoe the Donkey and The Walls of Limerick. Attendees may even accompany the band to play an instrument or sing-along. Comfortable attire recommended.

**Tues 28th & Thurs 30th | 18.30–20.30**

Marina Market, Centre Park Rd, Cork, T12 YX76



## Experiences

Please note places on these experiences are limited and should be pre-booked when registering for the conferences.



### Irish Food Lecture

Join Regina Sexton, Ireland's leading food and culinary historian, food writer, broadcaster and cook for a unique lecture on Irish food culture and history, complete with tastings of some of Cork's finest local produce.

**Wed 29th | 16.30–18.00**

WGB, G01



### Blarney Castle & Gardens

Built nearly six hundred years ago by one of Ireland's greatest chieftans, millions have since flocked to this world famous landmark to kiss the Blarney Stone and explore the world-famous gardens.

**Fri 31st | 13.45–17.45**

Blarney Castle, Blarney, Cork, Ireland



### Jameson Midleton Distillery Tour Experience

Discover the Heart and Soul of Irish whiskey at Midleton Distillery Experience. Home to seven iconic whiskey brands, enjoy a one-of-a-kind whiskey experience that takes you beyond process and taste and brings you to the very essence of Irish whiskey.

**Fri 31st | 13.45–17.45**

Old Midleton Distillery, Midleton, Co. Cork



## Abbreviations

<b>AAACE</b>	<b>American Association For Adult and Continuing Education</b>
<b>ASEAN</b>	<b>Association of Southeast Asian Nations</b>
<b>ASEF</b>	<b>Asia-Europe Foundation</b>
<b>ASEM</b>	<b>Asia-Europe Meeting</b>
<b>COLLO</b>	<b>Coalition of Lifelong Learning Organizations</b>
<b>EAEA</b>	<b>European Association for Adult Education</b>
<b>EERA</b>	<b>European Educational Research Association</b>
<b>EESC</b>	<b>European Civil Society Organisations and Networks</b>
<b>ESREA</b>	<b>European Society for Research on the Education of Adults</b>
<b>ETB</b>	<b>Education and Training Board</b>
<b>ILO</b>	<b>International Labour Organisation</b>
<b>LEED</b>	<b>Local Economic and Employment Development</b>
<b>OECD</b>	<b>The Organisation for Economic Cooperation and Development</b>
<b>RECLA</b>	<b>Continuing Education Network of Latin America and Europe</b>
<b>SEAMEO TED</b>	<b>Southeast Asian Ministers of Education Organization Technical Education Development</b>
<b>SEAMEO RIHED</b>	<b>Southeast Asian Ministers of Education Organization Regional Centre specialising in higher education and development</b>
<b>TVET</b>	<b>Technical and Vocational Education and Training</b>
<b>UCC</b>	<b>University College Cork</b>
<b>UPCEA</b>	<b>University Professional and Continuing Education Association</b>
<b>WGB</b>	<b>Western Gateway Building</b>



## Maps & Locations

Click or tap on any of the icons below to access Google map locations for each venue.



[Aula Maxima](#)



[Western Gateway Building \(WGB\)](#)



[Dr Dora Allman Room \(4th Floor\), The Hub](#)



[Common Room, Main Quad](#)



[Aine Hyland Room \(Ground Floor\), The Hub](#)



[Marina Market](#)



[North Wing Council Room, Main Quad](#)



[Visitor Centre, Main Quad](#)



[Izz Cafe](#)

[Click here to see a full UCC campus map](#)

[Click here to see all campus maps including toilets, bus routes, drinking fountains, eating places, heritage displays, biodiversity trail and shops.](#)

### The Hub

#### Ground Floor

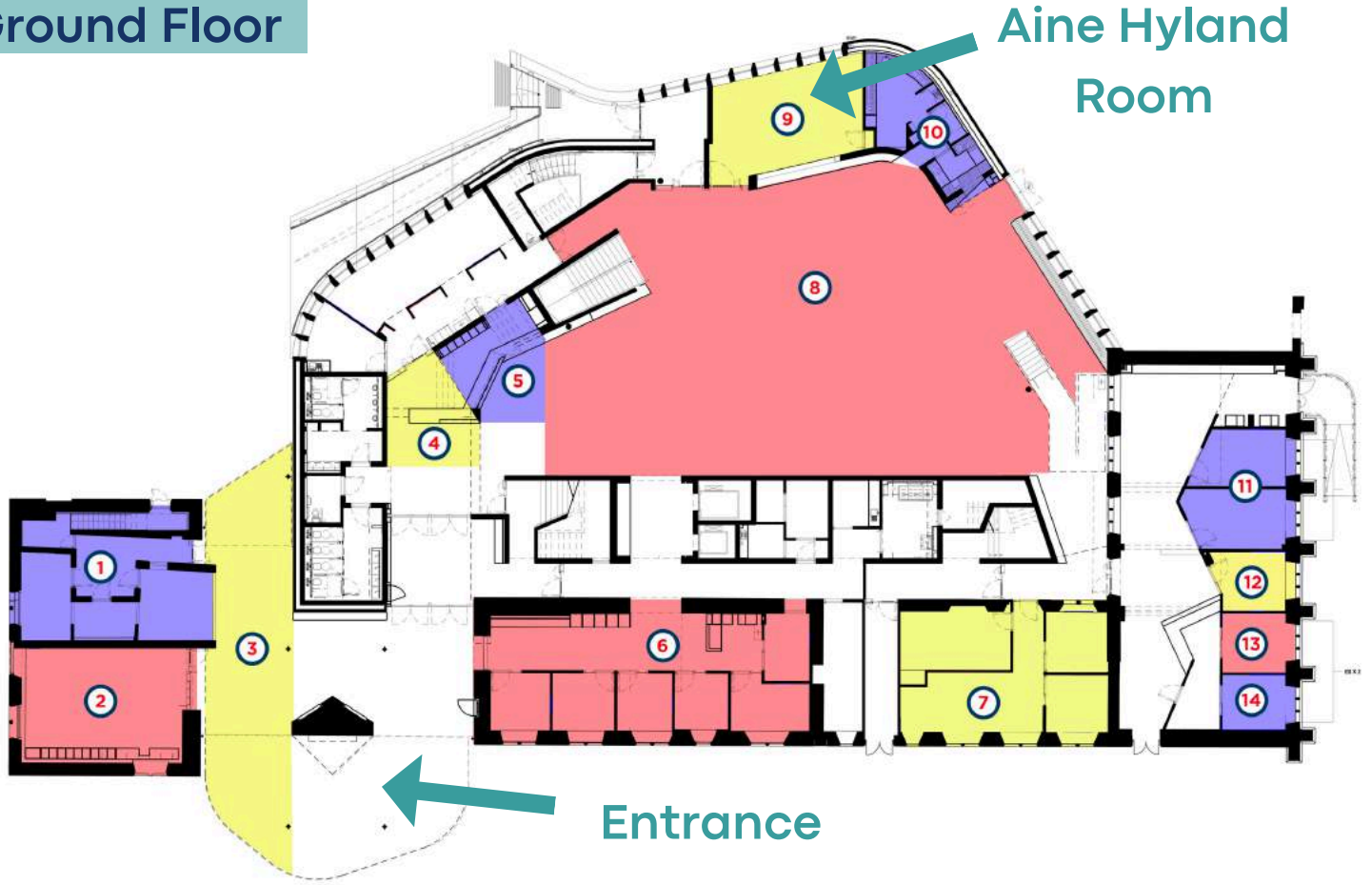

#### Fourth Floor

